

Total communication

UC scales are designed to be integrated in systems, which check and control the flow of goods, from entry to sales. METTLER TOLEDO supplies the relevant drives for instore and remote solutions. Network technology with Ethernet 10baseT, TCP/IP, ftp, DHCP cables.

Ethernet Access Point and Access Bridge produce the radio connection to your host computer power supply and any other additional devices. WLAN (in accordance with 803.11b) is especially suitable for applications, which require mobile communication and real-time data access.

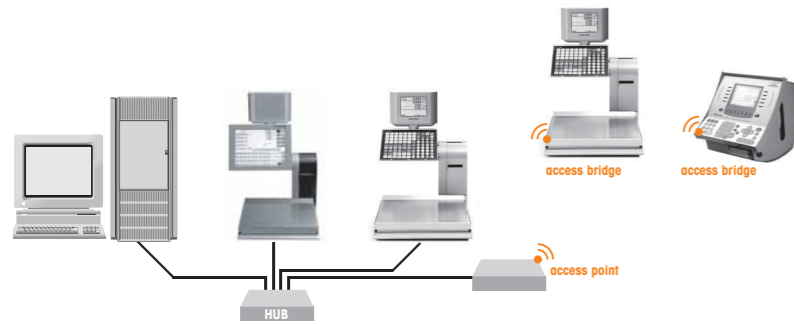

Retail Scales

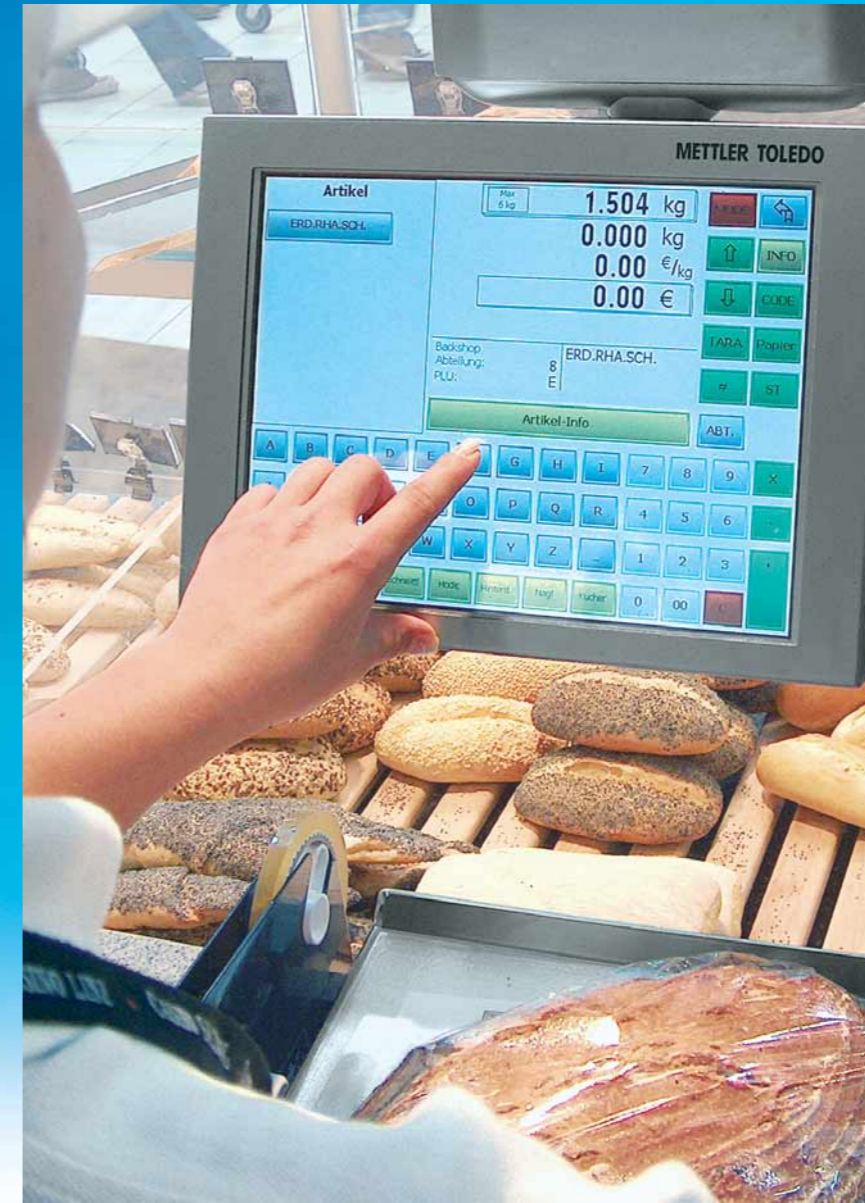

UC-h Touch

Information Center

Retail Scales



Austria **Mettler-Toledo GmbH**
Tel. +43-1-604 19 80
Fax +43-1-604 28 80
info.mtat@mt.com

Germany **Mettler-Toledo GmbH**
Tel. +49-641-507 456
Fax +49-641-507 350
info.mtd@mt.com

Switzerland **Mettler-Toledo (Schweiz) AG**
Tel. +41-44-944 45 45
Fax +41-44-944 45 10
info.ch@mt.com

All other countries
Mettler-Toledo GmbH
Greifensee, Switzerland
Tel. +41-44-944 22 11
Fax +41-44-944 31 70

Subject to technical changes
© 08/2005 Mettler-Toledo GmbH
Printed in Germany 22010837

www.mt.com

Additional information



Quality certificate
Development, production and testing in accordance with ISO 9001. Environment management system in accordance with ISO 14001.



"Conformité Européenne".
This symbol guarantees that our products comply with the latest guidelines.

Sales Support via Touch

METTLER TOLEDO

Innovation and Flexibility in a small space

- Simple connection using standard PC technology
- First alphanumeric search function for articles with no PLU numbers
- Intuitive updating of product information via central CMS
- 12" active touch color screen
- Individual colored layout of customer display
- Information center for individual customer requirements

Moving in the right direction.

The new UC-h Touch is designed to logically merge the PC with the balance. With the new type of alphanumeric article search function, the user is able to find the desired article selection, simply by entering two letters. The user is therefore quicker, more flexible and independent of location.

Touch function.

An individually designed color display gives the user a quick identification of the balance. All functions can be accessed via the Simple Touch functions and can be enabled depending on the user group.

Ergonomics and Design.

The design has been developed and implemented in accordance with ergonomic requirements and current operational procedures.

The design therefore provides optimum support to the daily commercial business. The weighing platform is embedded and hides all neces-

sary connection options to the front. The printer which is connected on the side produces a quick receipt or label even if goods are on the load plate. A clear display gives the best possible quality even in strong light.

No two requirements are the same.

METTLER TOLEDO has developed special software solutions for each individual requirement. A modular system ensures that only those components are selected, which are actually required.

For instance:

- Receipt or label
- Price marking
- Interactive Touch training for employees
- Creating reports
- Quick search for article with no PLU
- Proof of origin
- Acquisition of inventory data

Extremely easy to operate using the large 12.1 inch color display. Clear and intuitive keys, offering complete transparency.

The optimally illuminated customer display gives the customer a clear display which is easy and safe to read, even in strong light.

Printing options

- Using receipt, label
- Label and total label
- Receipt and total label
- Receipt and article label
- Adhesive total receipt
- Receipt with/without talon

Easy to clean for smooth, round stainless steel surfaces.

Serial RS 232 interfaces ensure individual connection of peripheral devices. A cash register drawer can also be connected. Other interfaces such as a USB port are also available.

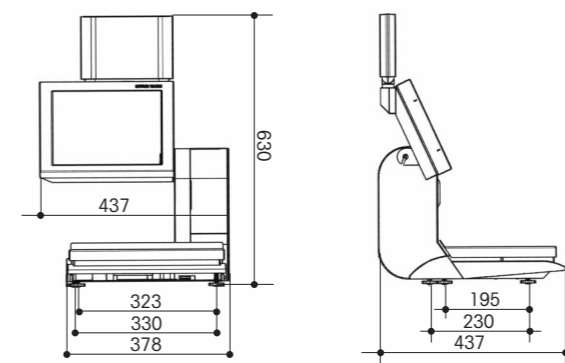

Technical Data

UC-h Touch

Weighing range	6 kg	15 kg	3 kg/6 kg	6 kg/15 kg	12 kg	30 kg
Graduation	2 g	5 g	1 g/2 g	2 g/5 g	2 g	5 g
Min. weight*	40 g	100 g	20 g	40 g	40 g	100 g

* EEC: Printout possible for min. weight, however not for price marking. Tare adjustment across the whole weighing range; automatic zeroing

Features

- Online help: Operational aid via text display
- Competence text for user
- Smiley function
- Receipt cancellation via receipt number
- Wide range of taring options
- Touch screen/keyboard for operator use

User forms

- Operation, Price marking, Large-scale sales, Using receipts, Label, Label and total label, Receipt and total label, Receipt and article search, Adhesive total receipt, Receipt with/without talon
- Conventional – by entering the PLU number using an alphanumeric search function; hits can be booked immediately
- Touch screen with alphanumeric keyboard and function keys

Display

- Backlit LCD display, VGA resolution of 320 x 240 points
- Weight display, 5 places
- Tare display, 5 places
- Base price display, 8 places
- Amount due display, 9 places
- 3-line text display, each with 20 characters (for the customer)
- Advertising via graphics on the customer's side
- On the user's side, displayed via a 12.1 inch touch screen (800 x 600 resolution)

Remote service/control

- FTP
- Screen viewer
- Data communication via Trans UC3

Reports

- Extensive and configurable reports with specific journal entry for external evaluations
- Intermediate, final and inventory reports
- Departmental, balance, group of articles, sales, PLU and time reports

Printer

- Select either receipt/label printer or double printer.
 - Linerless printer also available
 - Thermal printer, quick with graphics capability
 - Logo printout on receipt or label
 - Freely definable labels.
- (We offer the UC3-Label program for free creation of labels on a PC.)

Data memory

- 30 GB hard drive.

Interfaces

- 1 serial interface (max. 3 as option)
- 2 USB ports
- Optional modular spark-quenching in accordance with 802.11b
- Ethernet (10BaseT), TCP/IP, DHCP, DNS, FTP and other scale network interface
- Interface to control a cash register drawer
- Option to connect 2 PCMCIA cards, type I, II

Data supply/removal

- Via XML interface
- Data management
- Electronic journal
- External evaluation possible

* nach kundenindividuellen Anforderungen